

Ha[RM]onic Tiber

HISTORY

1880 Railyard

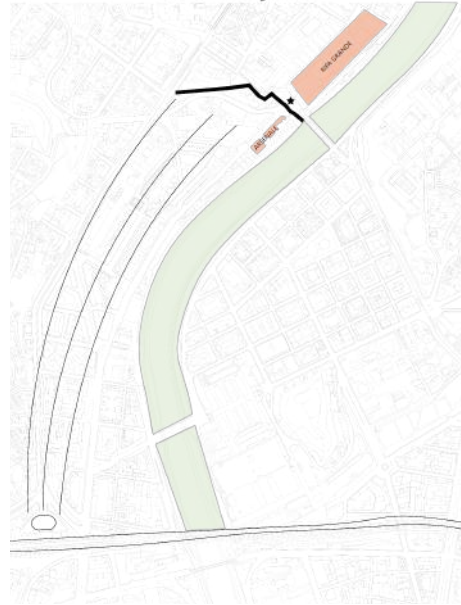

1940 Barracks

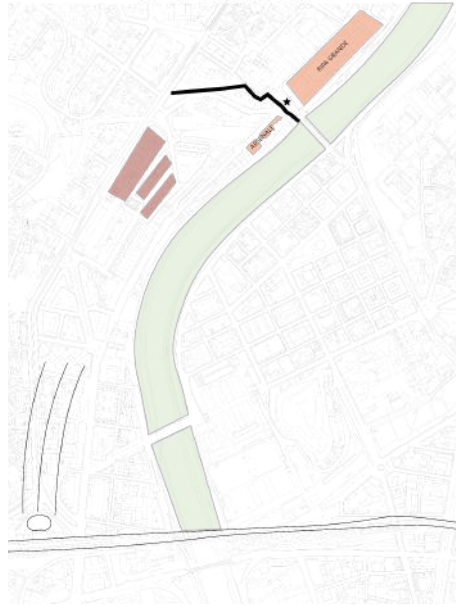

1931 Master Plan

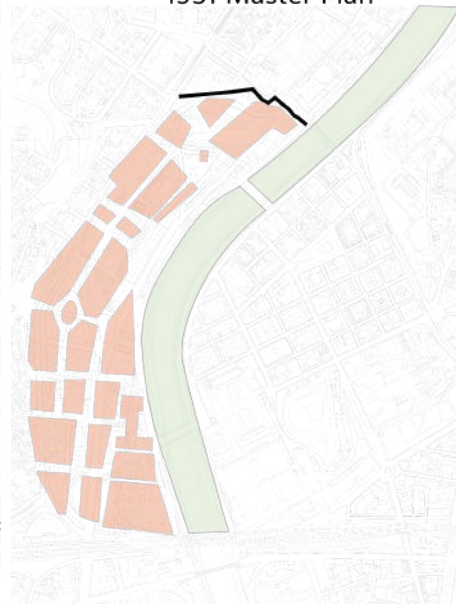

Late 1960s-70s Development to Current

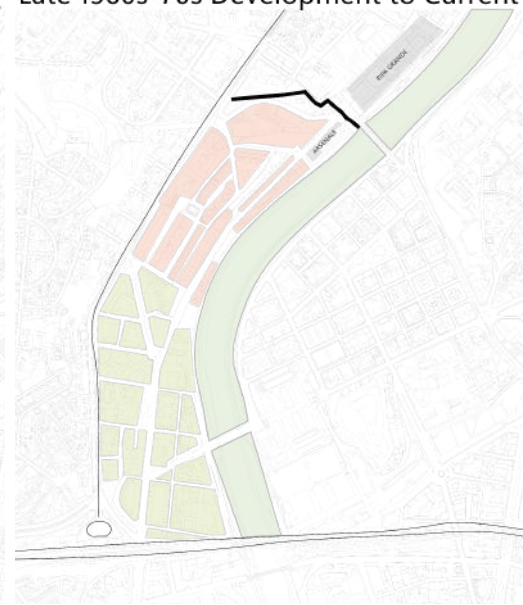

CIRCULATION



- Car Traffic
- Foot Traffic
- Bike Traffic
- Public Transportation
- Parking
- Parks

Market Access



Trail Access



Park Access



KEVIN LYNCH

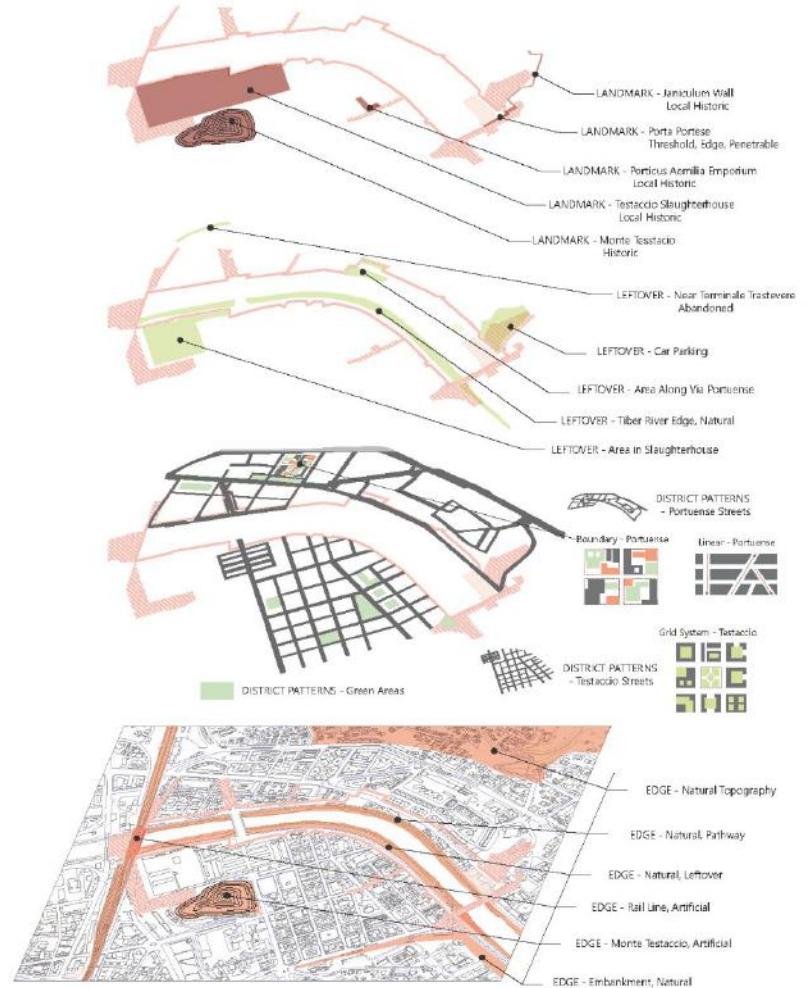

Vector Views

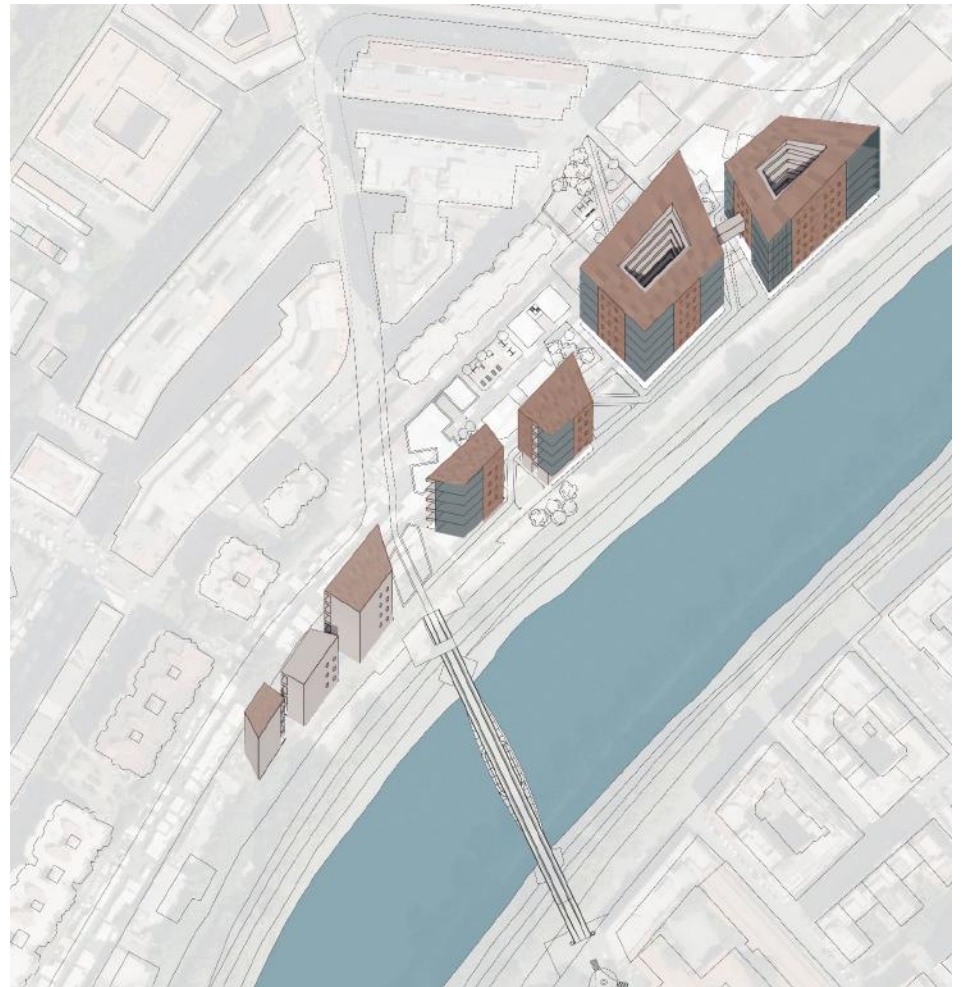

Pocket Village

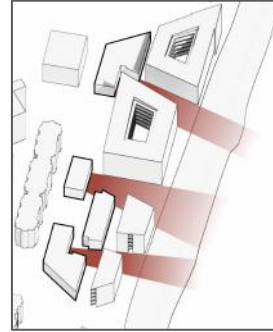

Urban Garden

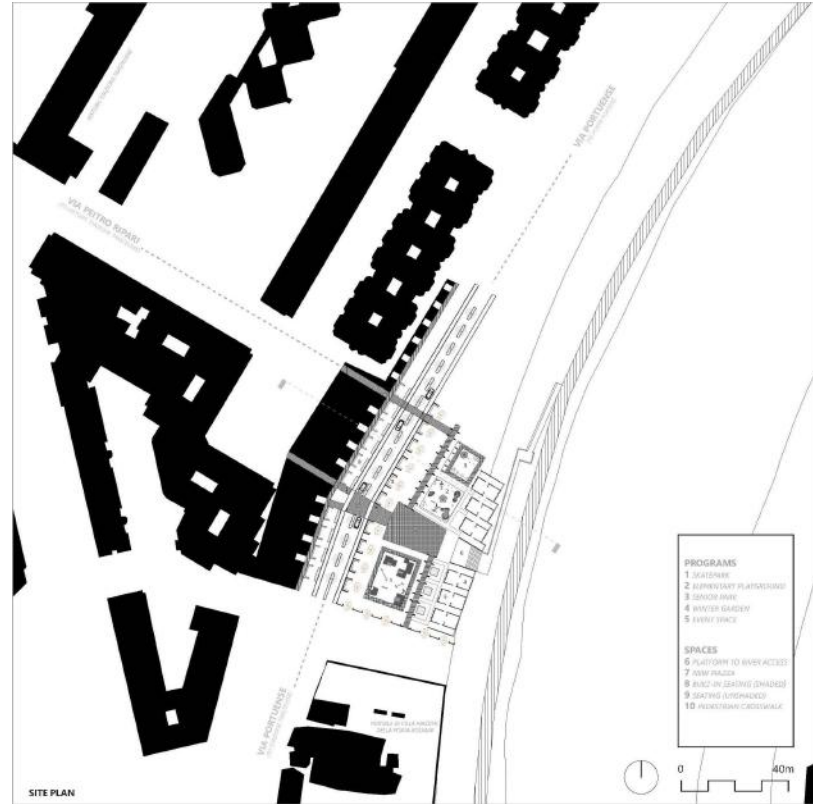
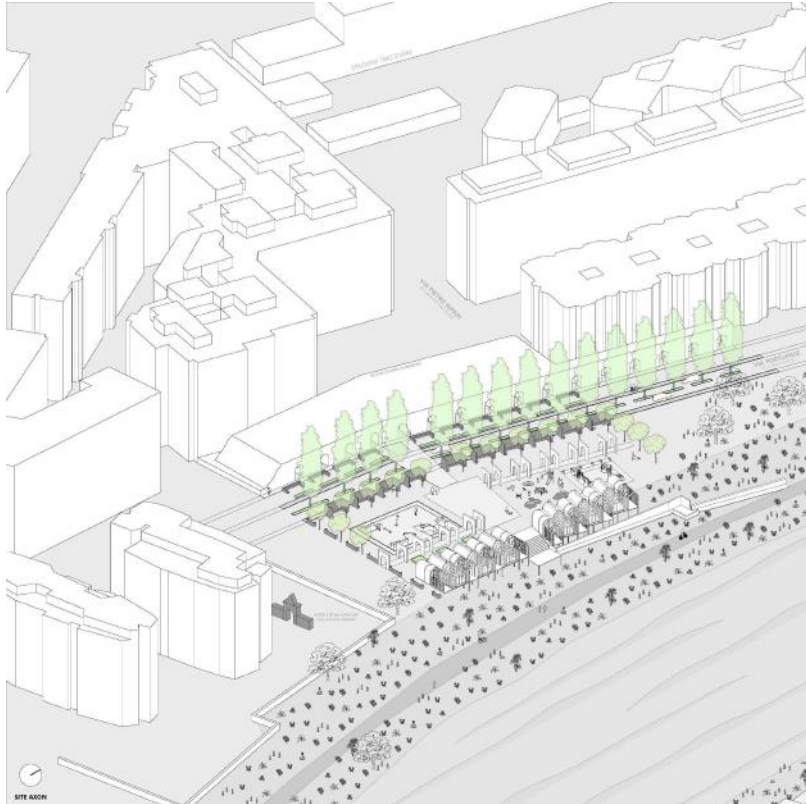

Harmonic View



Harmonic Connection

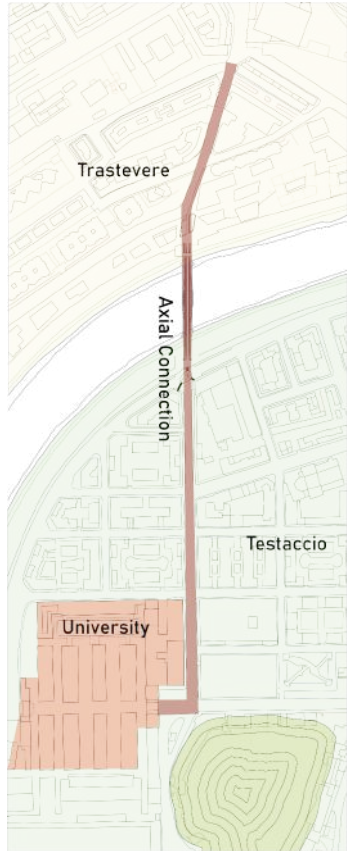

Axial Connection

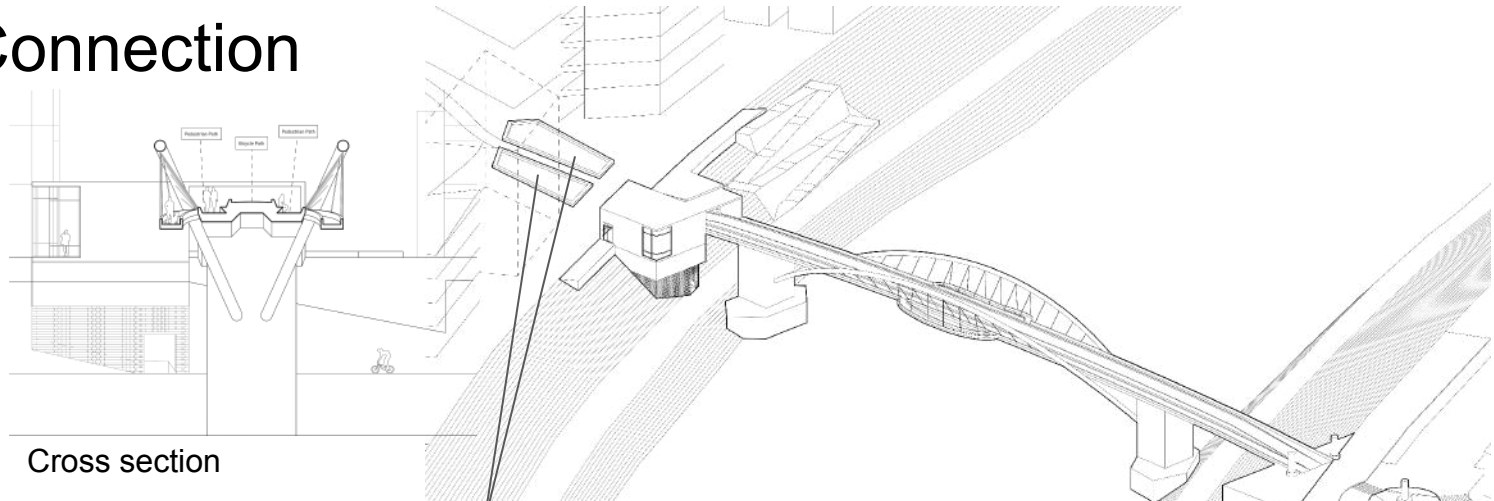

Cross section



Mini Big Forest Idea

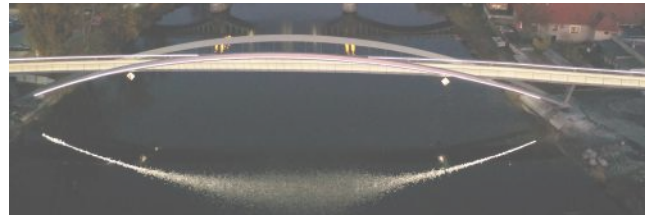

Precedent Study



Formwork Connection Diagram

Elevated Communities

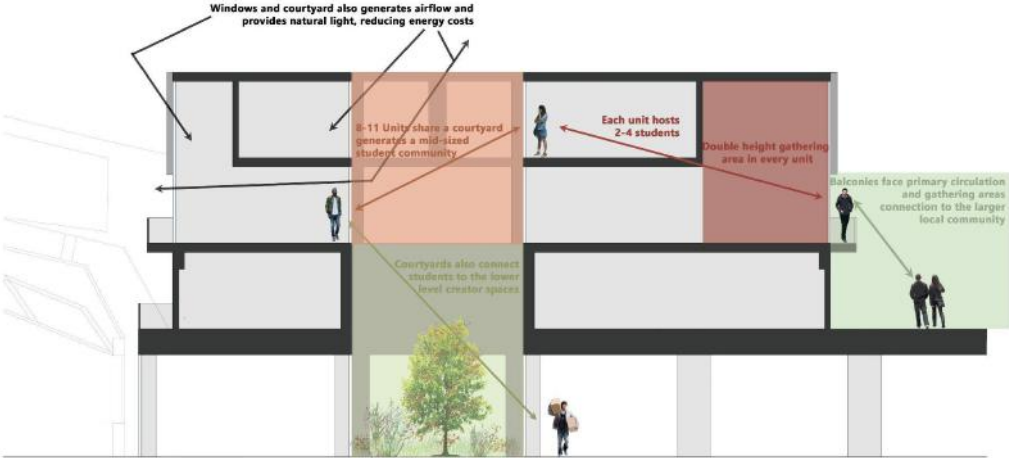

PROJECT ACTIONS	TIME	ACTORS	BUDGET
consultation and licensing for masterplan projects	2 - 4	Public and private companies	€
Land acquisition	2	Public and private companies	€€
Demolitions, decontamination, preservation, and cleaning	2 - 4	private companies/public	€€
bridge construction	2	Public companies	€€€
Campus housing construction	3	private companies	€€
Piazza construction	1	Public companies	€
Mixed-use construction	3	private companies	€€€
Craftsman's Hub construction	5	private companies	€€
Pedestrian paths, bicycle lanes, and road changes	2	public companies	€
Landscape and new green areas	5	private companies	€€€

PROBLEMS ADDRESSED

The area of Trastevere around Via Portuense was not initially made for people but for trains. Roads on the west of the river do not connect to each other, which creates strips of buildings blocking views and circulation out to the river. Today, the area suffers from excessive parking, empty and poorly made buildings, difficult transportation, a disconnection with and across the river, and very little sense of community.

POLICY IMPLEMENTATION

To solve the problems found in this area, this project first increases the urban plan's density to increase the area's capacity for the community. It introduces new circulation connections to create a 15-minute city. It introduces specialized residential buildings to cater to different people that might live here. It introduces infrastructure that primarily supports foot traffic and biking. It creates visual connections to and across the Tiber River. And, It introduces greenery and environmental practices into the area as well.

ACTIONS DESCRIPTION

- Create a Mixed-use residential, shopping, and maker space around the historic hanger
- Create Large-Scale mixed-use residential and shopping buildings along the river edge to promote a connection with the Tiber and Testaccio while increasing urban density
- Create Small-Scale mixed-use residential and shopping buildings around courtyards to foster community and increase greenery and urban density
- Create a piazza with gardens that grow food for the community, educational facilities to serve the community, and uses native plants to revive the Tiber's ecosystem
- Create a mixed-use residential building to serve the university in Testaccio
- Create a footbridge across the Tiber that connects the two neighborhoods
- Create lookout spots along the Tiber so people in Testaccio can have a stronger visual connection to Trastevere